

atmizoo
by atmizone

VapeSnail

user manual

This is the VapeSnail

The VapeSnail is Atmizone's new rebuildable atomizer concept for Billet Box and Boro compatible AIOs. With its amazing potential, real time access to deck, real time fixed air flow swap ability, easy refill system, easy rebuilding and complete package overall, the VapeSnail is much more than just another rebuildable, introducing a unique RTA experience to the users of Boro compatible AIOs.

What's in the box

- **1 x VapeSnail RTA with 510 Aux. Base** (1 x Chamber & Chimney Reducer pre-installed)
- **1 x Set of spares** (2 x Post Screws, 1 x O-ring Kit, 4 x AFC Fixed Tubes, 4 x MTL Pins, 1 x Tool)
- **1 x Set of User Guide / Warranty Card**

Features and specs

- **Air flow tuning** via 5 fixed AFC Tubes (pre-installed Pos. Tube with air hole D=4.0mm and alternative AFC Tubes 2/2.5/3/3.5mm) plus 4 MTL Pins (1/1.2/ 1.5mm/1.8mm pinned inside the Pos. Tube with D=4.0mm), all **replaceable real time** with full tank and rebuilt deck.
- M2.5mm pan head phillips **post screws**.
- PCTG Tank allowing **real time access** to Deck.
- 12.6mm **post-to-post space**, ~8.5mm **post-to-post net space**, ~8.0mm **coil space**.
- Max. **net coiling height** ~6.0mm (C & C Reducer out) / ~5.2mm (C & C Reducer in)
- **Chimney inner D** ~4.0mm (C & C Reducer out) / ~2.5mm (C & C Reducer in)
- **Height** 39.60mm [min] / **Weight** ~34g

The parts of the VapeSnail

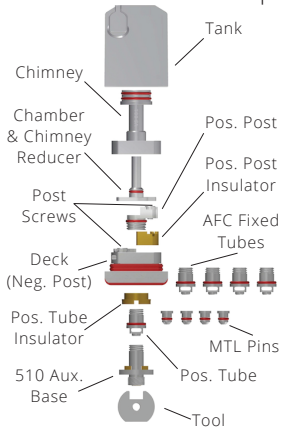

English

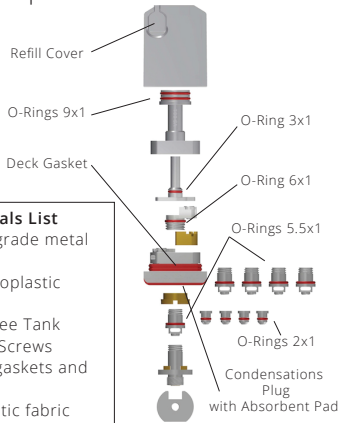

Materials List

- SS316 foodgrade metal parts
- PEEK Thermoplastic Insulators
- PCTG bpa free Tank
- SS304 Post Screws
- Foodgrade gaskets and o-rings
- Semi-synthetic fabric Absorbent Pad

Vaping on the VapeSnail



Grip on the tank section and pull up to access the deck (1a). Remove Plug (1b) and unscrew Pos. Tube off the deck (1c). Then screw the 510 Aux Base until fully in place (1d).

TIP To unscrew the Pos. Tube off the deck (1c) use the custom Tool.

TIP To remove a full tank and access deck, you have to turn the VapeSnail upside down. If not, the Tank will empty. Having it upside down, you can only access deck if liquid level is lower from the rim where chimney meets deck. Keep it upside down until back in the AIO.

English

Coiling! Fasten your coil down on the posts.

TIP The two small, half circle cut outs on the rims of the Deck serve as leads for your coiling rod to align the coil properly (2a). They also allow some extra space if you need to lower your setup right above the air hole.

TIP You can either fasten the coil legs on the left side of each post screw (2b - traditional way) for coils with more wraps / extra length, or on the right side of each post screw (2c) for more typical coils and overall shorter coils with less wraps.

Vaping on the VapeSnail



Wicking and the use of C & C Reducer.

TIP Trim legs of cotton along the rims of the deck (3a - black marking as minimum length). Legs should be long enough to reach the wells (3b), as this prevents the wick collapsing when soaked with juice. Also the cotton should be enough to ensure it will stand behind juice slots (3c) and hold liquid intake at proper levels. Don't overdo, but also don't be stingy.

TIP The VapeSnail comes with the C & C reducer pre-installed. This creates a restricted chamber and a narrow Chimney suitable for MTL builds. If you want to remove it, just insert your coil core guide through the top part and push down (4a).

English



Air Flow Tubes and Pins.

TIP You can adjust your air flow by installing any of the AFC Tubes with the help of the Tool. Preinstalled Pos. Tube (D=4.0mm) can also host the MTL Pins (4b). The Tubes not only control air flow right under coil but also serve as adjustable positive pole of the VapeSnail. Normally you screw them in all the way, but they can be adjusted lower if needed (4c).

TIP You can change AFC Tube (and consequently MTL Pin as well) any time, even with full Tank and a build on the Deck. When you do this, always grip the VapeSnail in one hand to make sure that the Tank will not open accidentally.

Vaping on the VapeSnail

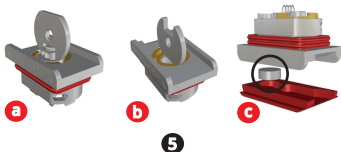

The Tool and the Plug.

TIP The Tool is a custom multi-purpose tool which will help you with installation of AFC Tubes (5a), assembly - disassembly of Pos. Tube Insulator (5b), but also to remove - restore the 510 adapter of your Billet Box / Boro compatible AIO.

TIP The Plug (5c) is a custom gasket which helps so that you will have minimum condensations (if any) inside your AIO. Its sealing function is supported by the Absorbent Pad (5c in circle), which absorbs any condensations piling up inside the air channel.

English



Refilling the Tank and more info.

TIP To refill, open the liquid port by lifting the refill cover (6a). Top up, then secure the refill cover back into place (6b). It is suggested to refill the Tank only when the VapeSnail is insided the AIO. This ensures that the tank section will be securely attached to the deck section and prevent accidents.

TIP If you are using the VapeSnail in an AIO with air intake through its door panels, the Plug should not be installed as it will hinder air flow. With some AIOs you will need to adjust the height of the AFC Pos Tube (see step 4).